

# U600MI/CI-19RS

## 6MP 1/1.8" Dry Gigabit Ethernet Industrial Area Scan Camera

U600MI/CI-19RS Pratt & Whitney Array Phase machine, equipped with IMX178 rolling shutter chip, built-in Various image preprocessing functions. Using Gigabit Ethernet network interface, fast real-time transmission of uncompressed data, Frame rate up to 19.1 fps.



### Features:

- Low-power platform with stable performance.
- Support WDR, noise reduction, sharpening and other ISP functions.
- Supports soft trigger, hard trigger and free running modes.
- Gigabit Ethernet interface, maximum transmission distance without relay 100m away.
- Compatible with GigE Vision V2.0 protocol and GenICam standard.

### Application industry:

Electronic semiconductor, factory automation, logistics, Codereading, pharmaceutical packaging, etc.

### Dimensions:

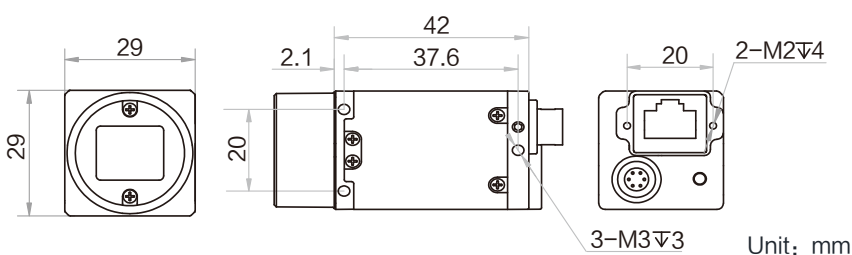

### Sensor:

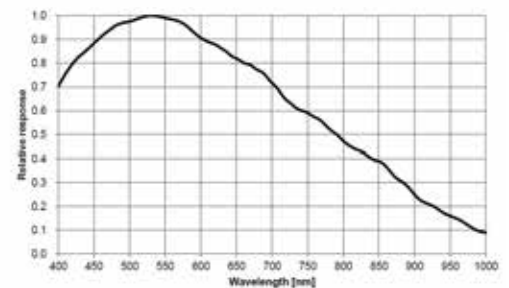

U600MI-19RS Quantum efficiency

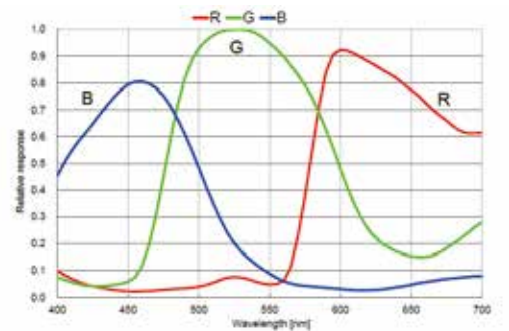

U600CI-19RS Quantum efficiency

### Order model:

Black and white camera:  
**U600MI-19RS**  
 Color camera:  
**U600CI-19RS**

## Technical parameter

Model	U600MI-19RS	U600CI-19RS
parameter	6MP 1/1.8" Dry Gigabit Ethernet Industrial Area Scan Camera	
Performance		
Sensor type	CMOS , Rolling shutter	
Sensor model	Sony IMX178	
Cell size	2.4 μm × 2.4 μm	
Target size	1/1.8"	
Resolution	3072 × 2048	
Maximum frame rate	19.1 fps @3072 × 2048	
Dynamic Range	71.3 dB	
Signal to noise ratio	41.3 dB	
Increase, benefit	0 dB ~ 24 dB	
Exposure time	25 μs ~ 2.5 sec	
Shutter mode	Support automatic exposure, manual exposure, one-key exposure mode	
B&W	Black and white	Color
Pixel format	Mono 8/10/10Packed/12/12Packed	Bayer GR 8/10/10Packed/12/12Packed
Binning	Support 1 × 1 , 2 × 2	
Downsampling	Support 1 × 1 , 2 × 2 , 4 × 4	
Mirror	Support horizontal mirroring, vertical mirroring output	
Electrical Characteristics		
Data interface	Gigabit Ethernet (1000Mbit/s) compatible with Fast Ethernet (100Mbit/s)	
Figure No I/O	The 6-pin P7 connector provides power and I/O: 1 optocoupler isolated input (Line0), 1 optocoupler isolated output (Line1),1 bidirectional configurable non-isolated I/O (Line2)	
Powered by	9 ~ 24VDC , PoE optional	
Typical power consumption	1.7 W@12 VDC	1.72 W@12 VDC
Structure		
Lens mount	C-Mount	
Dimensions	29 mm × 29 mm × 42 mm	
Weight	About 76 g	
IP protection class	IP30 (when the lens and cable are installed correctly)	
Temperature	Working temperature 0 ~ 50°C, storage temperature -30 ~ 70°C	
Humidity	20%~95% RH non-condensing	
General Specifications		
Software	Supports GigE Vision protocol software	
Operating system	Windows XP/7/10 32/64bits, Linux 32/64 bits and MacOS 64bits	
Protocol/Standard	GigE Vision V2.0, GenICam	
Certification	CE, FCC, RoHS, KC	