

U1200MI/CI-10RS

12MP 1/1.7" Dry Gigabit Ethernet Industrial Area Scan Camera

U1200MI/CI-10RS Pratt & Whitney Array Phase machine, equipped with Sony IMX226 rolling shutter chip, Built-in multiple image preprocessing functions. Gigabit Ethernet interface, fast real-time transmission of uncompressed data According to reports, the highest frame rate can reach 9.7fps.



Features:

- Low-power platform with stable performance.
- Support WDR, noise reduction, sharpening and other ISP functions.
- Supports soft trigger, hard trigger and free running modes.
- Gigabit Ethernet interface, maximum transmission distance without relay 100m away.
- Compatible with GigE Vision V2.0 protocol and GenICam standard.

Application industry:

Electronic semiconductor, factory automation, logistics, Codereading, pharmaceutical packaging, etc.

Dimensions:

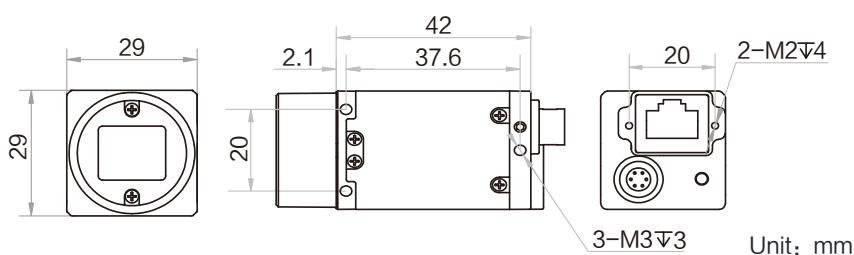

Sensor:

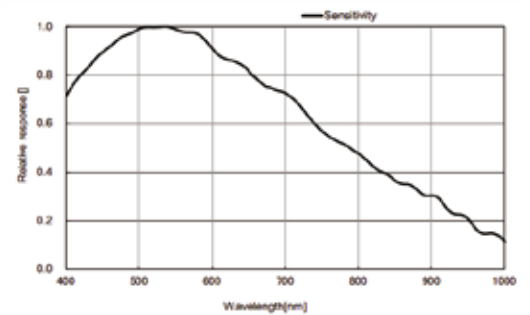

U1200MI-10RS Quantum efficiency

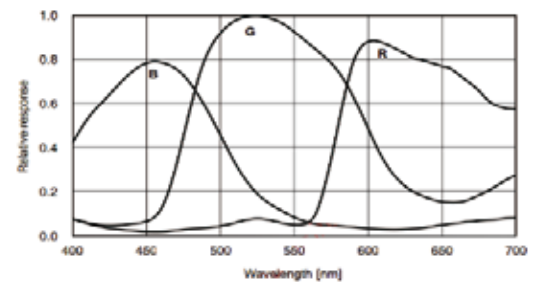

U1200CI-10RS Quantum efficiency

Order model:

Black and white camera :

U1200MI-10RS

Color camera :

U1200CI-10RS

Technical parameter

Model	U1200MI-10RS	U1200CI-10RS
Parameter	12MP 1/1.7" Dry Gigabit Ethernet Industrial Area Scan Camera	
Performance		
Sensor type	CMOS , Rolling shutter	
Sensor model	Sony IMX226	
Cell size	1.85 μm \times 1.85 μm	
Target size	1/1.7"	
Resolution	4024 \times 3036	
Maximum frame rate	9.7 fps @4024 \times 3036	
Dynamic Range	70.5 dB	
Signal to noise ratio	40.5 dB	
Increase, benefit	0 dB ~ 20 dB	
Exposure time	34 μs ~ 2 sec	
Shutter mode	Support automatic exposure, manual exposure, one-key exposure mode	
B&W	Black and white	Color
Pixel format	Mono 8/10/10Packed/12/12Packed	Bayer GR 8/10/10Packed/12/12Packed
Binning	Support 1 \times 1 , 2 \times 2 , 4 \times 4	
Downsampling	Support 1 \times 1 , 2 \times 2 , 4 \times 4	
Mirror	Support horizontal mirroring, vertical mirroring output	
Electrical Characteristics		
Data interface	Gigabit Ethernet (1000Mbit/s) compatible with Fast Ethernet (100Mbit/s)	
Figure No I/O	The 6-pin P7 connector provides power and I/O: 1 optocoupler isolated input (Line0), 1 optocoupler isolated output (Line1),1 bidirectional configurable non-isolated I/O (Line2)	
Powered by	9 ~ 24VDC , PoE optional	
Typical power consumption	1.78 W@12 VDC	1.82 W@12 VDC
Structure		
Lens mount	C-Mount	
Dimensions	29 mm \times 29 mm \times 42 mm	
Weight	About 76 g	
IP protection class	IP30 (when the lens and cable are installed correctly)	
Temperature	Working temperature 0 ~ 50°C, storage temperature -30 ~ 70°C	
Humidity	20%~80% RH non-condensing	
General Specifications		
Software	Supports GigE Vision protocol software	
Operating system	Windows XP/7/10 32/64bits, Linux 32/64 bits and MacOS 64bits	
Protocol/Standard	GigE Vision V2.0, GenICam	
Certification	CE, FCC, RoHS, KC	