

U500MI/CI-24RS(N) 5MP 1/2.5" Dry Gigabit Ethernet Industrial Area Scan Camera

U500MI/CI-24RS(N) Pratt & Whitney area scan camera, equipped with AR0521 rolling shutter chip, built-in various Image preprocessing function, which can be used under the change of light and dark scenes enough for stable imaging. With bandpass filter, adapt to red External fill light scene. Using Gigabit Ethernet interface, fast High-speed real-time transmission of uncompressed data, the highest frame rate can reach 24 fps.



Features:

- Low-power platform with stable performance.
- Support WDR, noise reduction, sharpening and other ISP functions.
- Supports soft trigger, hard trigger and free running modes.
- Gigabit Ethernet interface, maximum transmission distance without relay 100m away.
- Compatible with GigE Vision V2.0 protocol and GenICam standard.

Application industry:

Electronic semiconductor, factory automation, logistics, Codereading, pharmaceutical packaging, etc.

Dimensions:

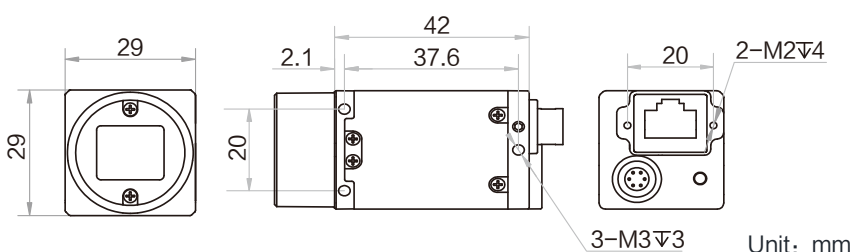

Sensor:

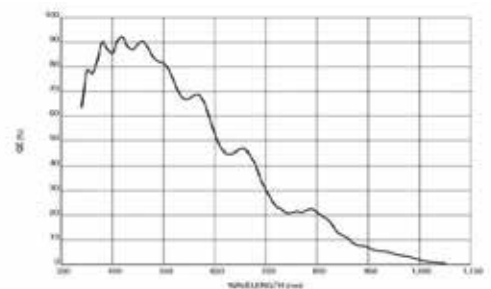

U500MI-24RS(N) Quantum efficiency

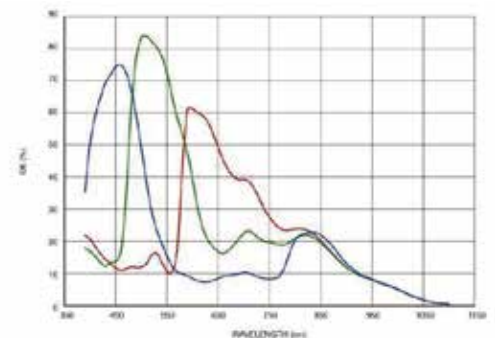

U500CI-24RS(N) Quantum efficiency

Order model:

Black and white camera :

U500MI-24RS(N)

Color camera :

U500CI-24RS(N)

Technical parameter

Model	U500MI-24RS(N)	U500CI-24RS(N)
parameter	5MP 1/2.5" Dry Gigabit Ethernet Industrial Area Scan Camera	
Performance		
Sensor type	CMOS , Rolling shutter	
Sensor model	AR0521	
Cell size	2.2 μm × 2.2 μm	
Target size	1/2.5"	
Resolution	2592 × 1944	
Maximum frame rate	24 fps @2592 × 1944	
Dynamic Range	63 dB	
Signal to noise ratio	37 dB	
Increase, benefit	0 dB ~ 15 dB	
Exposure time	21 μs ~ 1 sec	
Shutter mode	Support automatic exposure, manual exposure, one-key exposure mode	
B&W	Black and white	Color
Pixel format	Mono 8/10/10Packed/12/12Packed	Bayer GR 8/10/10Packed/12/12Packed
Binning	Support 1 × 1 , 2 × 2	
Downsampling	Support 1 × 1 , 2 × 2	
Mirror	Support horizontal mirroring, vertical mirroring output	
Electrical Characteristics		
Data interface	Gigabit Ethernet (1000Mbit/s) compatible with Fast Ethernet (100Mbit/s)	
Figure No I/O	The 6-pin P7 connector provides power and I/O: 1 optocoupler isolated input (Line0), 1 optocoupler isolated output (Line1),1 bidirectional configurable non-isolated I/O (Line2)	
Powered by	9 ~ 24 VDC	
Typical power consumption	1.78 W@12 VDC	1.81 W@12 VDC
Structure		
Lens mount	C-Mount	
Dimensions	29 mm × 29 mm × 42 mm	
Weight	About 76 g	
IP protection class	IP30 (when the lens and cable are installed correctly)	
Temperature	Working temperature 0 ~ 50°C, storage temperature -30 ~ 70°C	
Humidity	20%~80% RH non-condensing	
General Specifications		
Software	Supports GigE Vision protocol software	
Operating system	Windows XP/7/10 32/64bits, Linux 32/64 bits and MacOS 64bits	
Protocol/Standard	GigE Vision V2.0, GenICam	
Certification	CE, FCC, RoHS, KC	