

2K20-110-111

Specification

High-performance object-oriented telecentric lens

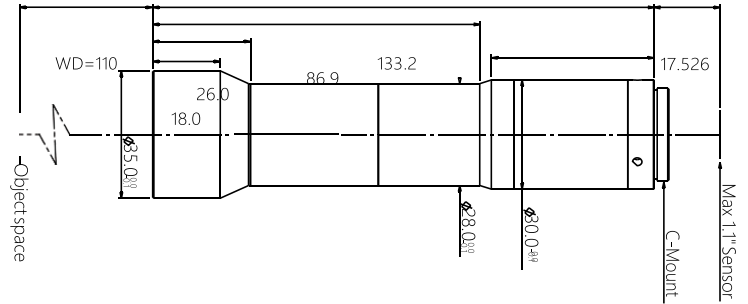

2K Series lens features

- Support high-resolution object-oriented telecentric lenses for 5M~20M pixel area scan cameras;
- A variety of low magnification designs to adapt to application scenarios with a larger field of view;
- High definition, low distortion, high telecentric, especially suitable for high-precision AOI and positioning applications;
- Long working distance specifications facilitate lighting and machine component layout;
- Built-in coaxial optical specifications are particularly suitable for wafers, glass devices, and display devices;
- Can be quickly customized to meet different camera specifications, as well as magnification, working distance, and depth of field requirements.

Optical parameters

Magnification $\beta(x)$	2.0
Working distance (mm)	110 \pm 2
CCD size (Φ mm)	18.0(1.1")
F/#	13.5
MTF30 (lp/mm)	>60
Object Depth of Field DoF(mm)	\pm 0.14@F13.5
Image distortion (% max)	<0.1
Telecentricity ($^{\circ}$ max)	<0.1

Mechanical parameters

camera interface	C
Overall lens length (mm)	133.2
Whether the coaxial light	No

Viewable range (mm x mm)

1" IMX183 (13.13x8.76)	6.6x4.4
1.1" IMX253 (14.19x10.38)	7.1x5.2